

Normal size of ceramic ferrule for stud welding

PF型

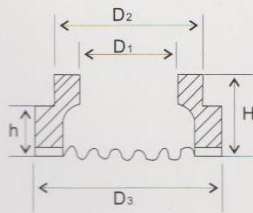

型号	尺寸	D ₁	D ₂	D ₃	h	H
PF6		5.6 ^{+0.5} ₋₀	8.5	11.5	3.3	6.5
PF8		7.4 ^{+0.5} ₋₀	11.5	15	4.5	6.5
PF10		9.2 ^{+0.5} ₋₀	15	17.8	4.5	8.5
PF12		11.1 ^{+0.5} ₋₀	16.5	20	6.5	9
PF16		15.0 ^{+0.5} ₋₀	20	26	7	11
PF20		18.6 ^{+0.5} ₋₀	30.7	33.8	8	10
PF24		22.4 ⁺¹ ₋₀	30.7	38.5	14	18.5
PF-12-2		11.1 ^{+0.5} ₋₀	20	23.8	3.3	6.5

UF型

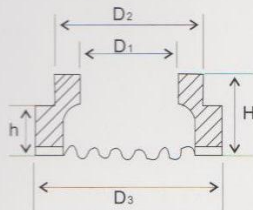

型号	尺寸	D ₁ ^{+0.5} ₋₀	D ₂ ±1	D ₃ ±1	h	H
UF6		6.2	9.5	11.5	4.7	8.7
UF8		8.2	11	15	4.7	8.7
UF10		10.2	15	17.8	5.2	10
UF12		12.2	16.5	20	6	10.7
UF13		13.1	20	22.2/26"	6.5	11
UF15		15.3	20	26	3.6	7.5
UF16		16.3	26	30	9.5	13
UF19		19.4	26	30.8	14	16.7
UF22		22.8	30.7	39	14	18.6
UF25		26	35.5	41	16.5	21

RF型

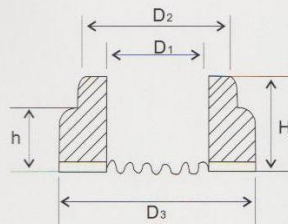

型号	尺寸	D ₁ ^{+0.4} ₋₀	D ₂ ±1	D ₃ ±1	h	H
RF6		6.2	9.5	12.2	6	10
RF8		8.2	12	15.3	5.5	9
RF10		10.2	15	18.5	7.5	11.5
RF12		12.2	17	20	8	13
RF16		16.3/14"	20.5/26.2"	26.5/32.5"	10.8/4.5"	15.3/8.8"
PF20		17.5/20.3"	26.2/28.5"	32	5/11.5"	9/22"
PF24		21/24.3"	30.4	36	6/12"	12/25"

Also we can make according to drawing! Material and color can be according to your requirement!

CERATEK TECHNICAL CERAMIC CO., LIMITED

Email: info@ceratek.net Web: www.ceratek.net

Tel/Fax(shanghai,china): +86 21 33876960